



100' Tractor Tug

Hull # S-149 – M/V Valor



Specifications:

Length.....100'
 Beam.....40'
 Draft.....17'
 Fuel Capacity.....70,840 Gallons
 Fresh Water Capacity.....8,000 Gallons
 Sewage.....1,400 Gallons
 Customer.....BayDelta Maritime

Deck Equipment:

- One Hawser Winch: DEPC-52
- TSW Winch: Jon Rie A525

Bollard Pull.....85 tons
 Speed.....14 Knots
 Auxiliary Engines.....2 x Caterpillar @ 215 KW
 Propulsion UnitsZ-Drives
 Maine Engines.....2 x Caterpillar 3516C @ 3356 HP each

Accommodations:

- One Captain's Stateroom
- One Engineer's Stateroom
- Three Crew Staterooms
- One Mess Room
- One Galley

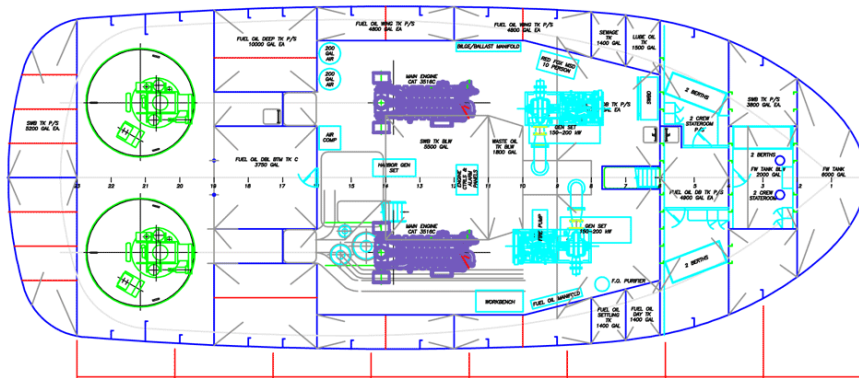
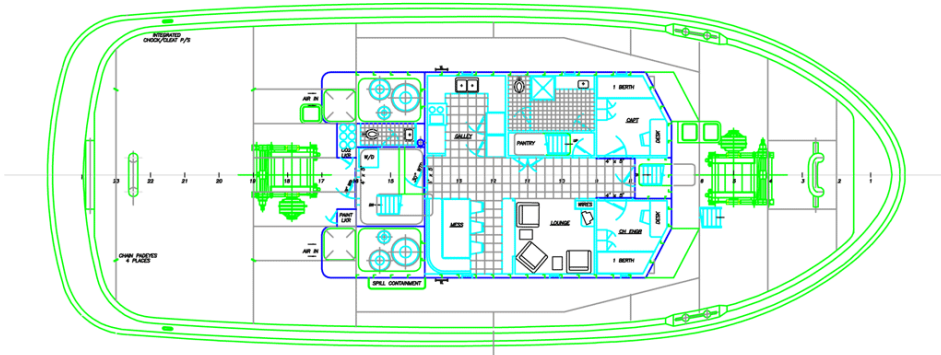
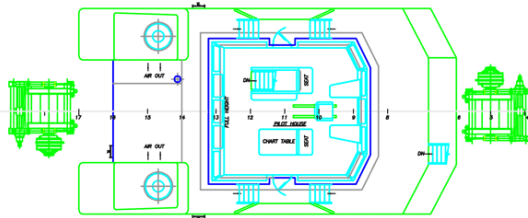
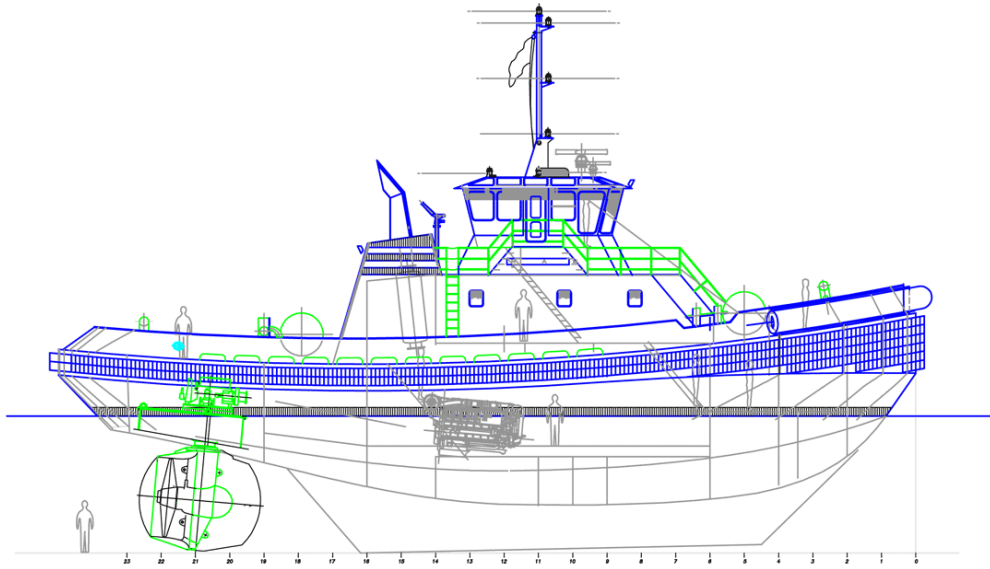

Nichols Brothers Boat Builders, Inc.
Phone: (360) 331-5500 – Fax: (360) 331-7484
www.nicholsboats.com – sales@nicholsboats.com