



Overnight Boat

Hull # S-110 – Queen of the West



Specifications:

Length 232'
 Beam 50'
 Draft 7'
 Fuel Capacity 15,000 Gallons
 Fresh Water Capacity 15,000 Gallons
 Sewage 15,000 Gallons
 Customer American West Seam Boat Co.

Propulsion 26' Diameter Stern wheel
 Main Engines 2 x 12V396MTU @ 1750 HP each
 Auxiliary Engines 2 x 500 KW each
 Speed 12 Knots
 Overnight Passenger Capacity 167
 Overnight Crew Capacity 60

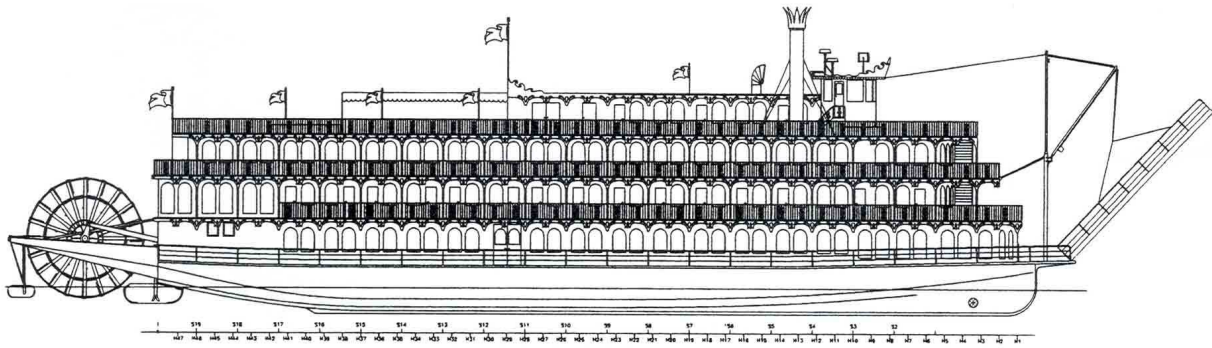

OUTBOARD PROFILE

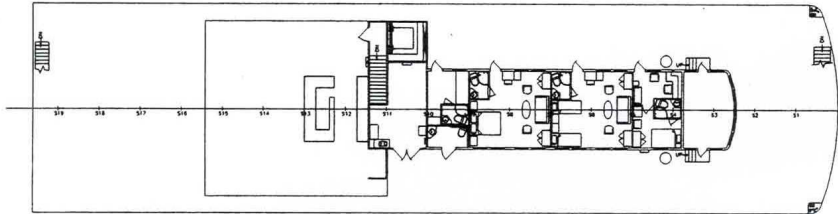

WEATHER DECK (VISTA VIEW DECK)

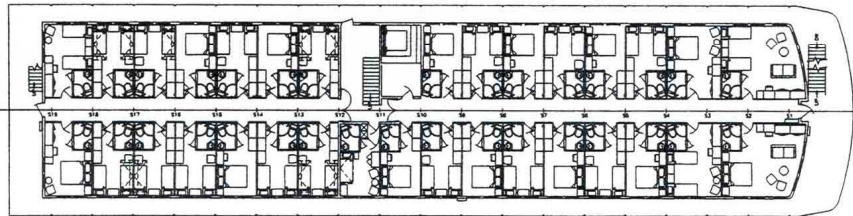

TEXAS DECK (GREAT RIVERS DECK)

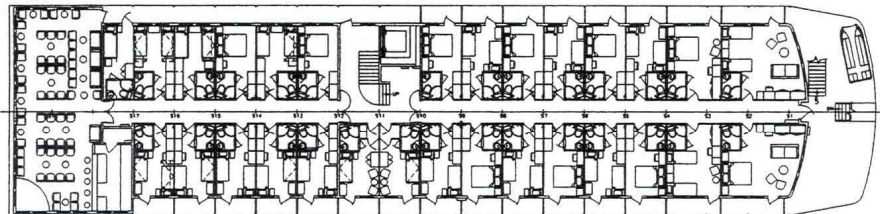

UPPER DECK (STERNWHEELER DECK)

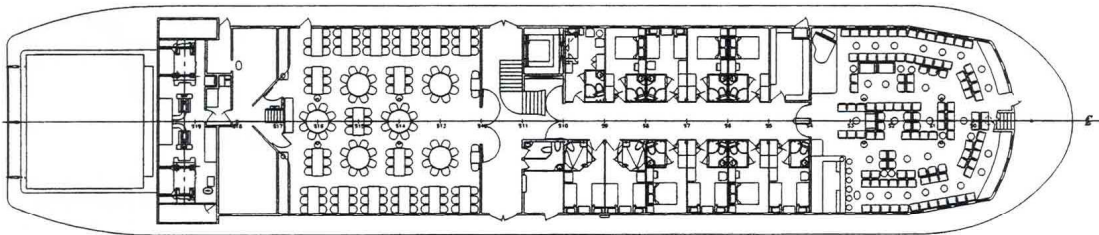

BOILER DECK (EXPLORER DECK)

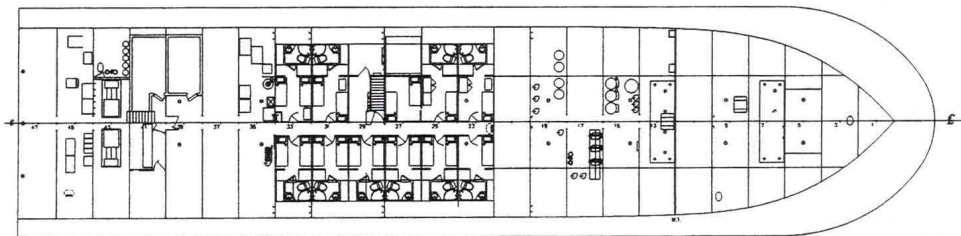

BELOW MAIN DECK



Nichols Brothers Boat Builders, Inc.
 Phone: (360) 331-5500 – Fax: (360) 331-7484
www.nicholsboats.com – sales@nicholsboats.com