



Dinner Boat

Hull # S-101 – M/V Star of Honolulu



Specifications:

Length	232'	Main Engines	2 @ 1125 HP each
Beam	45'	Auxiliary Engines	3 @ 115 KW each
Depth (main deck)	19'	Passengers	2000
Draft	13'	Crew	150

232' Excursion Vessel

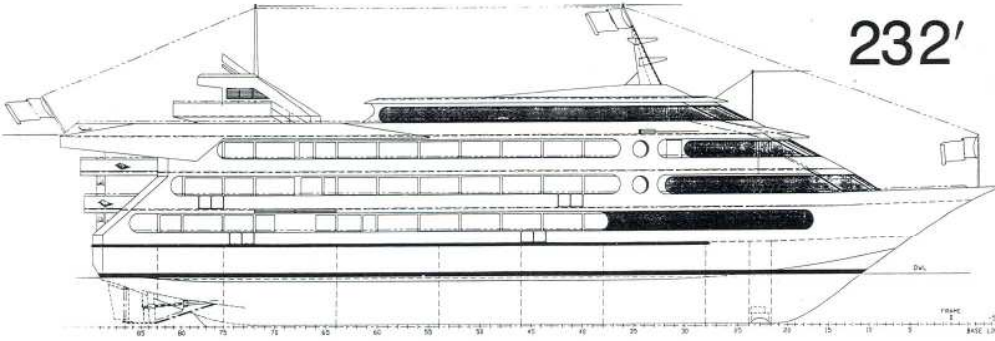

OUTBOARD PROFILE

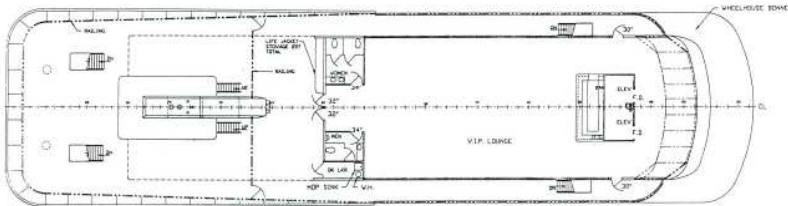

LOUNGE DECK

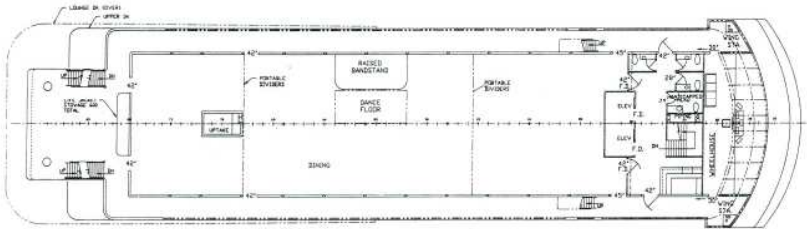

BRIDGE DECK

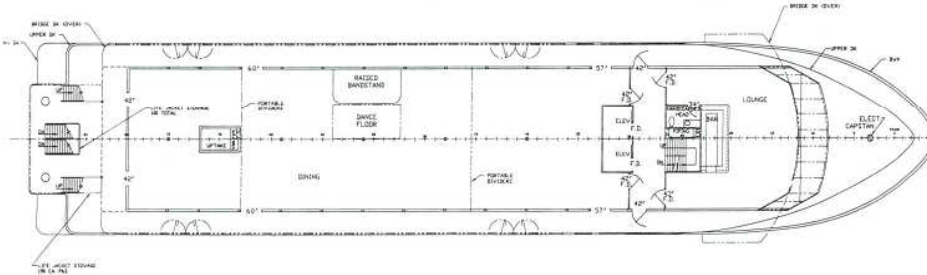

UPPER DECK

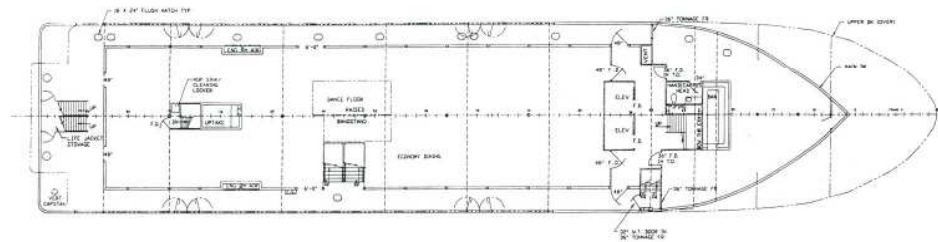

MAIN DECK

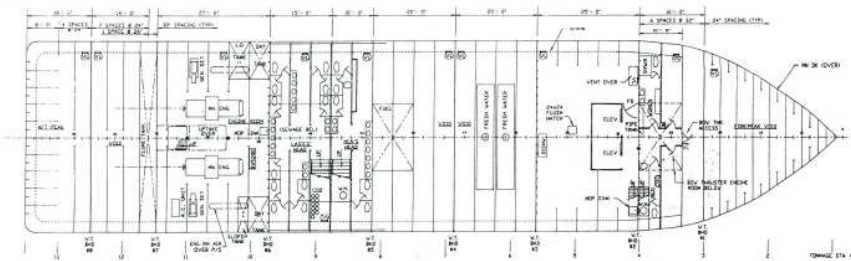

SECOND DECK



Nichols Brothers Boat Builders, Inc.
Phone: (360) 331-5500 – Fax: (360) 331-7484
www.nicholsboats.com – sales@nicholsboats.com